

Auger Tube Restrictor Kit

Tailgate Spreaders

PARTS LIST

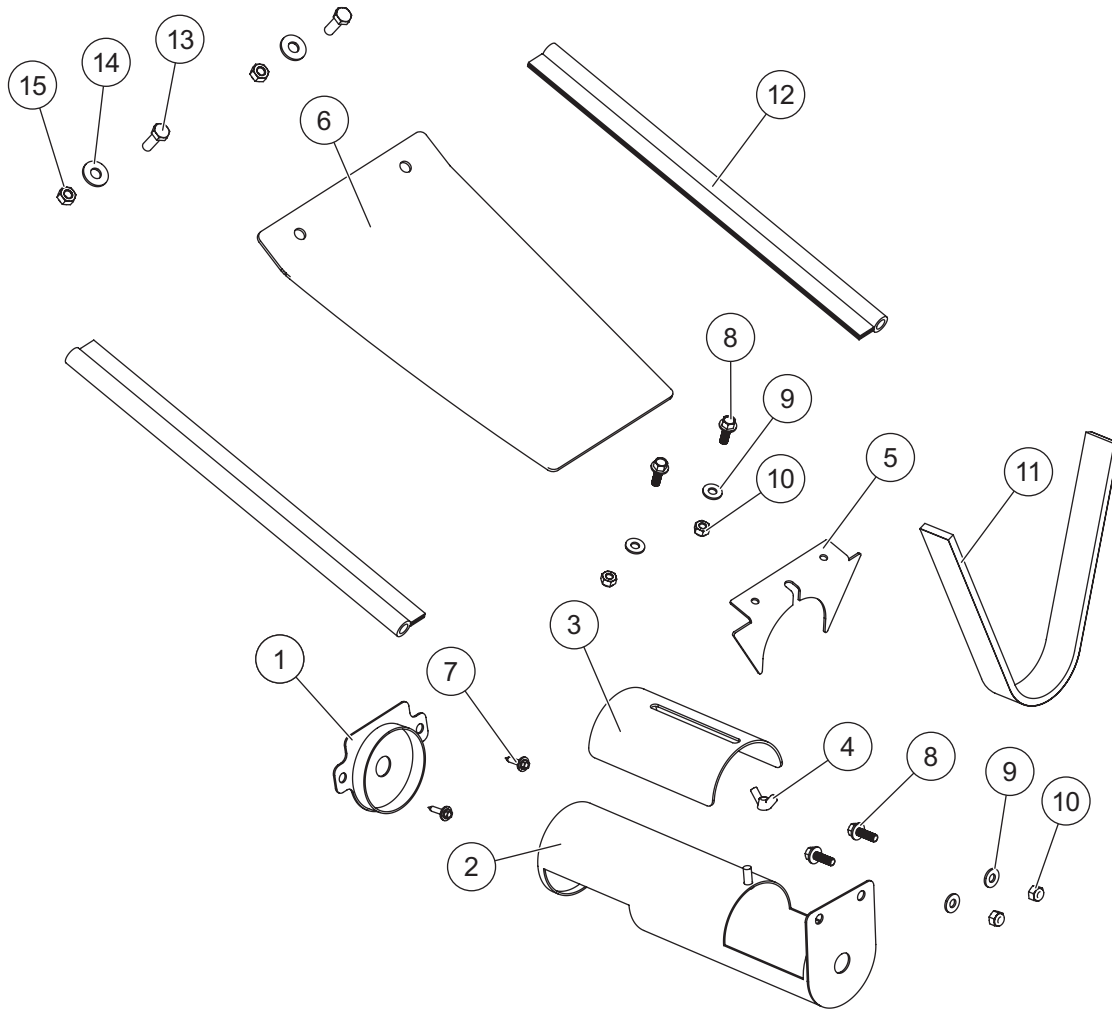

TRK-1575, 75913 Auger Tube Restrictor Kit							
Item	Part	Qty	Description	Item	Part	Qty	Description
1	74112	1	Auger End Cap	9		4	1/4 Flat Washer SS
2	74117	1	Auger Tube	10		4	1/4-20 Hex Locknut SS
3	74118	1	Gate Slide	11	T30012	1	Foam, 18"
4		1	1/4-20 Wing Nut SS	12	T30008	1	Edge Grip Seal, 30"
5	74124	1	Baffle Bracket	13		2	5/16-18 x 1 Hex Cap Screw
6	75870	1	Material Baffle	14		2	5/16 Flat Washer
7		2	#8 x 3/4 Driller Screw	15		2	5/16-18 Hex Locknut
8		4	1/4-20 x 3/4 Hex Cap Screw	ns		11	1/4 x 3/4 x 1/2 Retainer, Black
			Serrated Flange SS	ns		6	3/16 x .354 Rivet, Black Aluminum
ns = not shown				SS = Stainless Steel			

⚠ WARNING

Do not exceed GVWR or GAWR ratings as found on the driver-side vehicle door cornerpost.

⚠ CAUTION

Read this document before installing the auger tube restrictor kit.

⚠ CAUTION

Use standard methods and practices when attaching spreader and installing accessories, including proper personal protective safety equipment.

INSTALLATION INSTRUCTIONS





1. Park the vehicle on a smooth, level, hard surface, such as concrete. Turn the vehicle ignition to the "OFF" position and remove the key.
2. Empty hopper of all material. Remove the spreader power plug from truck wire harness. Ensure spreader is not powered. If desired remove spreader from truck for ease of access to auger and baffle components.

Disassembly





1. Remove cover and top screen. Set them and all associated hardware aside.
2. Remove the spreader baffle and associated hardware. Set all aside. The vibrator mounting plate does not have to be removed.
3. Loosen the auger set screw. The set screw is on the auger in the spreader tub and connects the gearbox output shaft to the auger. If the set screw is not visible, the auger may need to be rotated. If needed, remove the spreader tub from the frame to loosen the two bearing set screws.

Recommended Fastener Torque Chart

Inch Fasteners Grade 5 and Grade 8

Size	Torque (ft-lb)		Size	Torque (ft-lb)	
	 Grade 5	 Grade 8		 Grade 5	 Grade 8
1/4-20	8.4	11.9	9/16-12	109	154
1/4-28	9.7	13.7	9/16-18	121	171
5/16-18	17.4	24.6	5/8-11	150	212
5/16-24	19.2	27.3	5/8-18	170	240
3/8-16	30.8	43.6	3/4-10	269	376
3/8-24	35.0	49.4	3/4-16	297	420
7/16-14	49.4	69.8	7/8-9	429	606
7/16-20	55.2	77.9	7/8-14	474	669
1/2-13	75.3	106.4	1-8	644	909
1/2-20	85.0	120.0	1-12	704	995

Metric Fasteners Class 8.8 and 10.9

Size	Torque (ft-lb)		Size	Torque (ft-lb)	
	 Class 8.8	 Class 10.9		 Class 8.8	 Class 10.9
M6 x 1.00	7.7	11.1	M20 x 2.50	325	450
M8 x 1.25	19.5	26.9	M22 x 2.50	428	613
M10 x 1.50	38.5	53.3	M24 x 3.00	562	778
M12 x 1.75	67	93	M27 x 3.00	796	1139
M14 x 2.00	107	148	M30 x 3.50	1117	1545
M16 x 2.00	167	231	M33 x 3.50	1468	2101
M18 x 2.50	222	318	M36 x 4.00	1952	2701

These torque values apply to fasteners except those noted in the instructions.

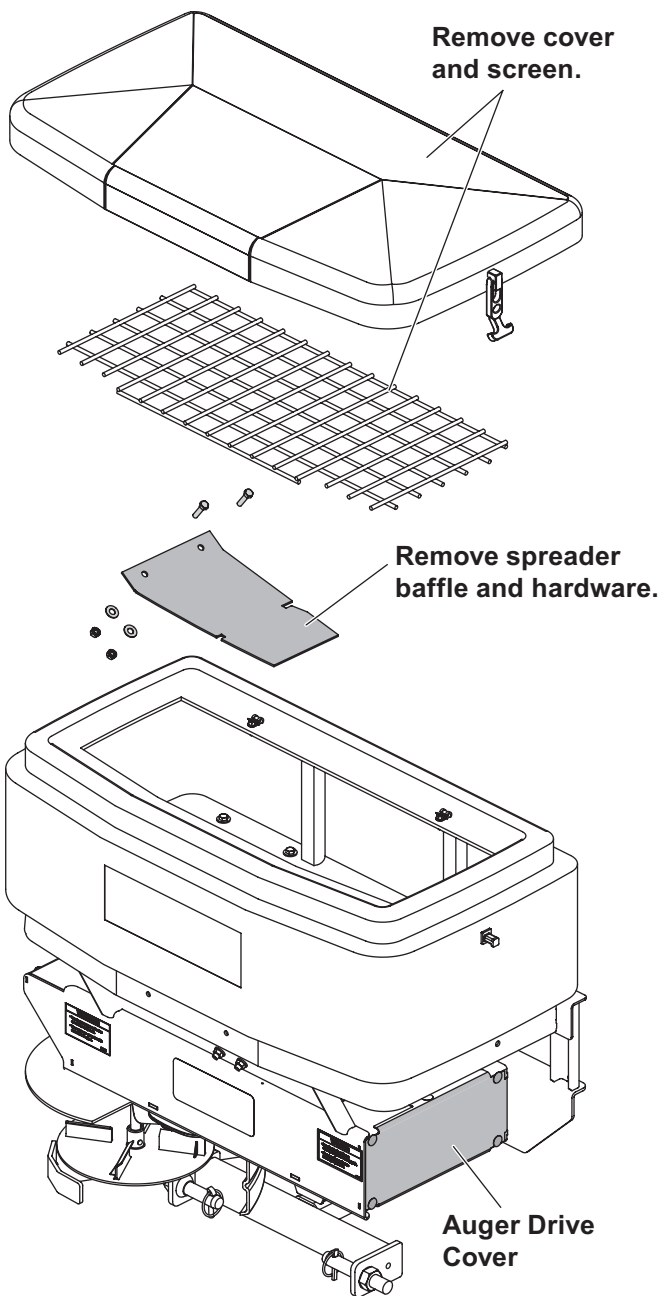

4. Remove the auger drive cover. Set the cover and all hardware aside. Remove all four bolts that hold the motor and gearbox to the frame. Slide the motor and gearbox out of the frame. Once the gearbox is removed, the auger can be removed.

Reassembly/Installation

1. Slide the auger into the auger tube. Place the end cap on the auger tube and install the foam seal as needed to prevent material from falling out of the auger tube. Replace all components back into the spreader tub in the reverse order they were removed.

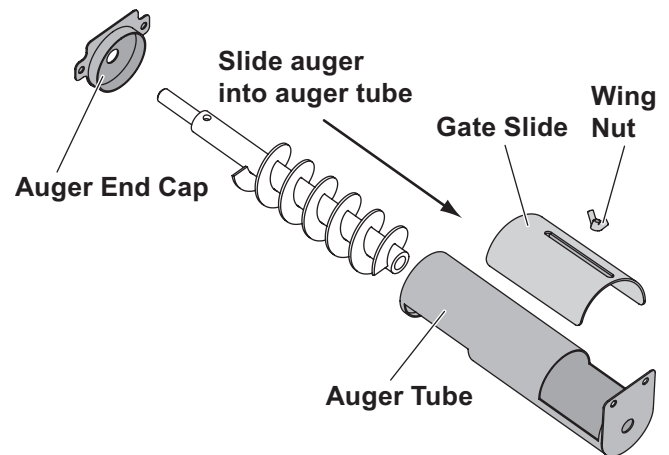

2. Install the motor and gearbox back into the frame. The gearbox output shaft will slide into the auger as before. Attach the gearbox mounting hardware to the hopper frame and tighten fasteners finger tight. Make sure the auger set screw is on the flat of the gearbox output shaft and tighten it down. Once the auger set screw is fully tightened, tighten the gearbox mount bolts according to the torque chart.

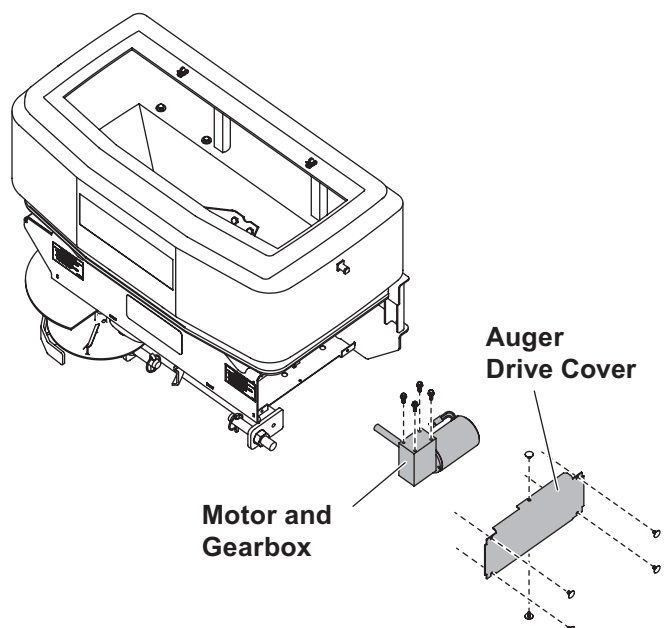

3. Position the auger so that the auger and auger tube sit unobstructed in the hopper tub. Once the tube is positioned, mark the mounting holes on the auger gearbox side position.

⚠ CAUTION

Before drilling holes, check to be sure that no vehicle wiring or other components could be damaged.

4. Drill 5/16" holes in designated spots and insert hardware. Tighten the fasteners finger tight. On the spinner motor side, mark the mounting position of the end cap and use the #8 tapping screws to attach the mounting end cap to the hopper tub. Tighten all hardware according to the torque chart.
5. Using the material baffle bracket and the material baffle that was set aside earlier, line up the baffle bracket and mark the position. Drill the 3/16" holes in the baffle where marked. Install the hardware. Tighten fasteners according to the torque chart.
6. Set the baffle in and align the bracket against the auger tube. Mark the position for the bracket hardware on the baffle. Drill holes in the baffle and install hardware.
7. Once the baffle bracket and baffle are combined, install the rubber seals around both. The rubber seals will need to be cut to length. Then mount the baffle and seals to the hopper tub with hardware. If necessary, drill new holes for the baffle to attach it to the hopper tub.

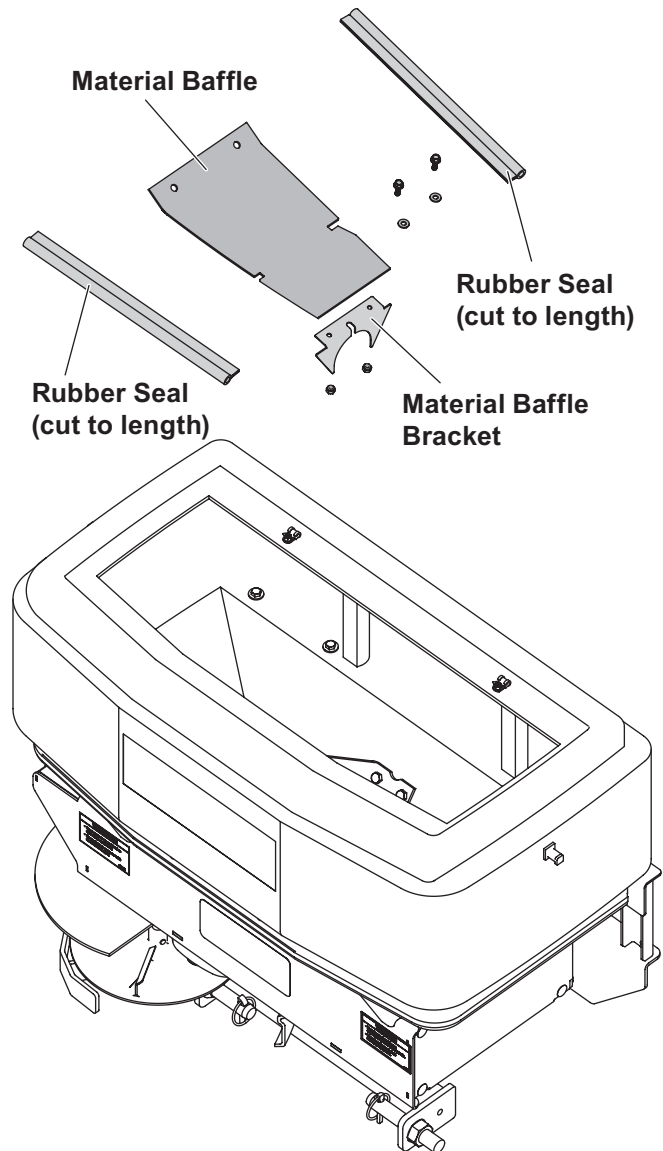

8. Reinstall the auger drive cover with the supplied black push retainers. Reinstall the top screen and spreader cover.

Copyright © 2017 Douglas Dynamics, LLC. All rights reserved. This material may not be reproduced or copied, in whole or in part, in any printed, mechanical, electronic, film or other distribution and storage media, without the written consent of the company. Authorization to photocopy items for internal or personal use by the company's outlets or spreader owner is granted.

The company reserves the right under its product improvement policy to change construction or design details and furnish equipment when so altered without reference to illustrations or specifications used. This equipment manufacturer or the vehicle manufacturer may require or recommend optional equipment for spreaders. Do not exceed vehicle ratings with a spreader. The company offers a limited warranty for all spreaders and accessories. See separately printed page for this important information.